

- NOTES:
- 1) Tolerances unless stated:
 Linear: $\pm 0.01\text{mm}$,
 Angular: $\pm 0.015^\circ$
 - 2) Remove all burrs
 - 3) Do not scale
 - 4) Surface texture: $\sqrt{1.6}$

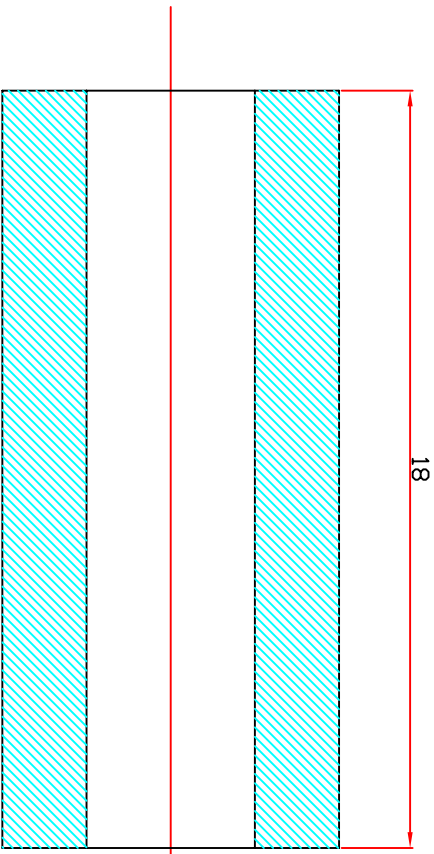

Section A : A

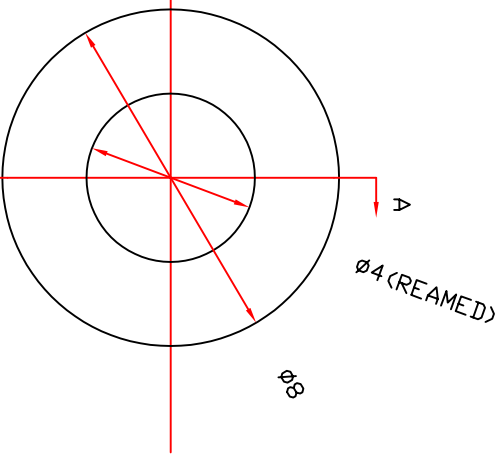

THIRD ANGLE PROJECTION DRAWING PREPARED IN ACCORDANCE TO BS308		GENERAL SURFACE FINISH: $\mu\text{m CLA R}_a$ UNLESS OTHERWISE STATED		DIMENSIONS: mm		TITLE MICE TARGET- Magnet Core		ALL PROPRIETARY RIGHTS IN THE SUBJECT MATTER HEREOF ARE RESERVED BY SHEFFIELD UNIVERSITY AND NO PERMISSION IS GRANTED TO REPRODUCE ANY PART IN WHOLE OR IN PART, OR TO DISCLOSE ANY OF THE INFORMATION UNLESS IT TO OTHERS.	
MATERIAL Mild Steel - EN8		HEAT & SURFACE TREATMENT		ISSUE DATE 17/10/07		INITIAL ISSUE NOTES		SCALE: 1:1 DATE: 17/10/07	
UNIVERSITY OF SHEFFIELD DEPARTMENT OF PHYSICS & ASTRONOMY SHEFFIELD S3 7RH Tel: 0114-2223543		DRAWN: M. MOHAMMAD		RAL REF: TD-SU_06		DRAWING NUMBER		A4	